

## QUICK START GUIDE



1 CHARGING PORT

2 USB-A

3 POWER BUTTON

4 VOLUME CONTROL

5 POWER SUPPLY

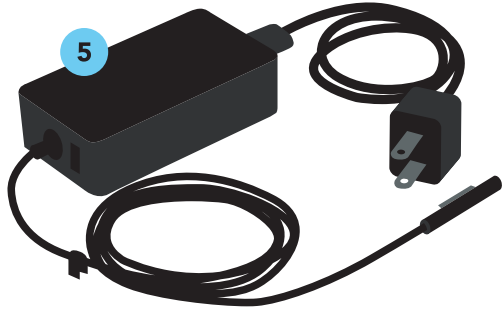

## CHARGING YOUR TRILOGY:

1. On the right side of the Trilogy, beneath the USB port, you will see a magnetic port to connect the charging cable.
2. When the charging cable is correctly placed, you will see a white light indicating the device is charging.

## DAILY USE

1. Turn On the Trilogy by pressing the Power Button.
2. When both devices are charged, you're ready to connect. Locate the Control Bionics application on the desktop and open the NeuroNode Controller Application.
3. Shake-to-Wake can be used to bring the NeuroNode<sup>3</sup> out of standby mode once it's removed from the charger. Gently shake the NeuroNode<sup>3</sup> and it will transition out of standby; this will be indicated by a series of lights shown on the NeuroNode<sup>3</sup> signal indicator.
4. From the NeuroNode Controller Application, select "Connect to NeuroNode." Once connected you will see the Graph Screen.
5. When you're ready to end the session, go to the NeuroNode Controller Application and select the Main Menu. From the Main Menu, select the Standby Icon which will put the NeuroNode<sup>3</sup> into Standby as indicated by a solid light on the NeuroNode<sup>3</sup> signal indicator. Place the NeuroNode<sup>3</sup> on the charger until you're ready to connect again.



Connect to NeuroNode



MAIN MENU



STANDBY

# WELCOME TO THE CONTROL BIONICS TEAM

## QUICK START GUIDE NEURONODE<sup>3</sup>

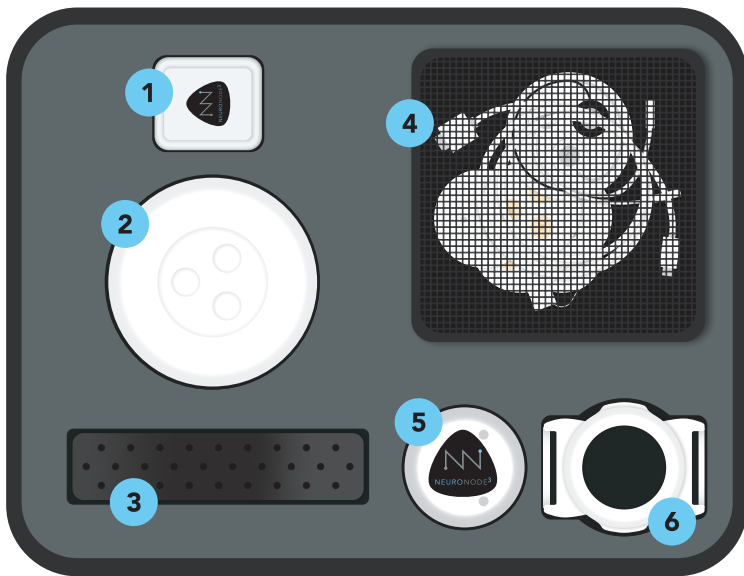

**1 WALL PORT**

**2 CHARGING  
BASE**

**3 NEUROSTRAP**

**4 ACCESSORY  
KIT**

Charging Cable;  
Non-Adhesive, Reusable  
Electrode; and Leadwire  
Adapter Base

**5 NEURONODE<sup>3</sup>**

**6 NEUROBAND**

## CHARGING YOUR NEURONODE<sup>3</sup>

1. Connect the charging base to the wall port using the charging cable in the accessory kit. A green light will appear on the charging base to indicate it's powered.
2. Align the charging indicators on the charging base with the active electrode indicators (two indentions) on the NeuroNode<sup>3</sup>.
3. While your NeuroNode<sup>3</sup> is charging, you should see two lights on the charging pad: red and green. Once fully charged the red light will turn off.

The signal indicator on the NeuroNode<sup>3</sup> will also indicate its battery level when charging.

Yellow: Too Low To Use  
Blue: Partially Charged  
Green: Fully Charged



## FEATURES

### **A ACTIVE ELECTRODE INDICATORS**

The Active Electrode indicators help you with placement while using the NeuroNode<sup>3</sup> in EMG mode. They're indicated on the top of the NeuroNode<sup>3</sup> as two small indentations.

### **B SIGNAL INDICATOR**

The Signal indicator is located on the top of the device and changes with use. A solid signal indicator light means that the device is in standby; the color of this light will change according to the battery levels as previously noted. A flashing red light means the NeuroNode<sup>3</sup> is Bluetooth broadcasting to your device. A flashing green light indicates the user has successfully made a switch in either EMG or Spatial mode.

## NEED SUPPORT? WE ARE HERE

USA +1 855-831-7521  
AU +61 3 9897 3576